

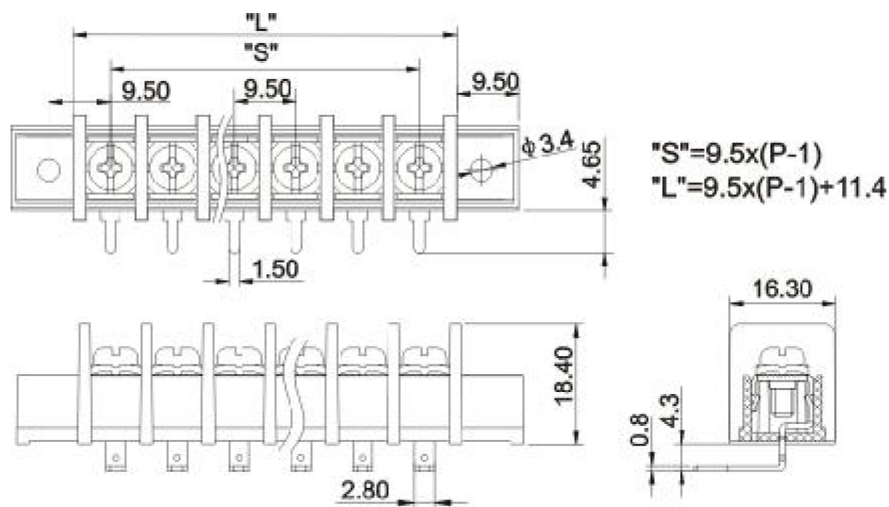

<b>Approval</b>	UL	CE
<b>Electrical</b>		
<b>Standard</b>	UL	IEC
Rated voltage	300V	750V
Rated current	25A	32A
Wire range	22-12AWG	4.0mm <sup>2</sup>
With standing voltage	AC2000V/1Min	
Insulation Resistance	500MΩ /DC500V	
<b>Mechanical</b>		
Max. Torque Value	1.2N.m 10.6Lb.in	
Ambient temperature	-40℃~+105℃	
<b>Dimensions</b>		
Pitch	9.5mm(.375")	
Poles	2P-20P	
<b>Material</b>		
Housing	PA66,UL94V-0	
Terminal	Brass,0.8t,Tin Plated	
Screws	Steel,M4 Ni Plated	

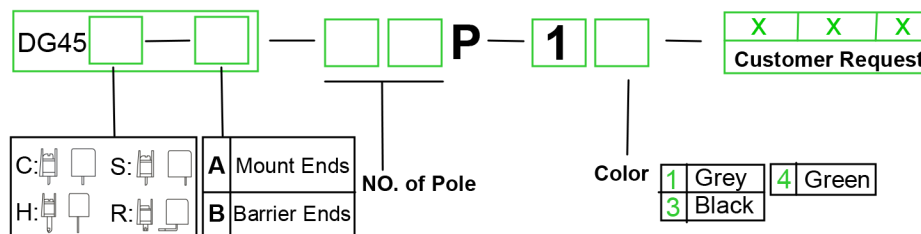

### HOW TO ORDER :



<b>Poles</b>	2	3	4	5	6	7	8	9	10	11	12	13	14	15
<b>L(mm)</b>	20.90	30.40	39.90	49.40	58.90	68.40	77.90	87.40	96.90	106.40	115.90	125.40	134.90	144.40
<b>S(mm)</b>	9.50	19.00	28.50	38.00	47.50	57.00	66.50	76.00	85.50	95.00	104.50	114.00	123.50	133.00
<b>Poles</b>	16	17	18	19	20	21	22	23	24	25	26	27	28	
<b>L(mm)</b>	153.90	163.40	172.90	182.40	191.90	201.40	210.90	220.40	229.90	239.40	248.90			
<b>S(mm)</b>	142.50	152.00	161.50	171.00	180.50	190.00	199.50	209.00	218.50	228.00	237.50			

	China · Kang Wei electronics co., LTD
	<b>NAME</b> <b>45R-A</b>